



Platteville Elementary 2020-2021 Guide For Parents

Calendar

Schedule for first week:

Monday, Aug 17	Tuesday, Aug 18	Wed., Aug 19	Thurs, Aug 20	Friday, Aug 21
			First Day of School! HALF DAY- dismissal at 1:00 PM Lunch provided	HALF DAY- dismissal at 1:00 PM Lunch provided

Schedule for the first six weeks and Remote Learning Mondays

The original school calendar had students attending in person for the first 6 Mondays. Now, every Monday, in-person students will be required to complete an iReady lesson by logging into their iReady account from home. The completed lesson will serve as your student's attendance for that Monday.

Mondays WITH remote learning:

- August 31
- September 14
- September 21
- September 28

Monday	Tuesday	Wednesday	Thursday	Friday
Remote Learning- iReady Online Lesson	In-Person Learning	In-Person Learning	In-Person Learning	In-Person Learning

Four Day School Weeks

Weld Re-1 and Platteville Elementary will have 4 day school weeks for the remainder of the calendar, with one exception- the four Mondays in April. This will Support Testing.

Cohort Groups

The cohort groups at Platteville Elementary are a grade level, therefore we will have 7 cohorts:

Cohort	Current Count (in-person)
Preschool	19
Kindergarten	28
First Grade	27
Second Grade	29
Third Grade	42
Fourth Grade	41
Fifth Grade	37

Each cohort has a primary aide that supports everything for that grade level, work room tasks and student related tasks. This aide will also cover lunch and recesses with support if needed.

Some cohorts have a secondary aide that will support special populations and the grade level in general. This structure will minimize social contact throughout the building.

Arrival Procedures

1. Students MAY NOT be dropped off before 7:45 AM. We will not have staff outside to monitor students before 7:45 AM. Students may be dropped off any time between 7:45-8:05 AM; after 8:05, students are considered tardy and should be dropped off at the front entrance.
2. Students riding the bus must wear a mask while on the bus.
3. ALL students need to be dropped off on the NORTH (Salisbury & parent drop-off/pick-up) side of the building at our usual parent drop-off/pick-up. We will be lengthening the drop off zone and will have more staff present to help kids out of their cars. Since only staff and students can be inside the building unless by appointment, we encourage parents to stay in the vehicles when dropping off.

4. Many students dropped off at parent pick up will go through the breezeway to access their classroom's outside door. This includes:
 - a. Kindergarten- entry is the west kinder door
 - b. First Grade- entry is the corner hallway door
 - c. Seivley
 - d. Hall
 - e. Pardo
 - f. Laird
 - g. Larson
 - h. McGirl
 - i. Heldt- students will go up ramp to classroom

Please see the map below for where your child will enter the building in the AM

5. Several rooms have doors on the front of the building facing east. This is along a large sidewalk at the west end of the parking lot. Classes that will head that way are:
 - a. Rosebrock
 - b. Juarez
 - c. Munro
 - d. Robinson
6. Classes that enter the building on Salisbury (North)
 - a. Bunting
7. At 7:45 AM, students will head directly to their classroom's outside door and immediately enter the building. The teacher will take your child's temperature and ask if they need breakfast. Students will then ease into the school day reading a book, finishing a project, or preparing for the day.
8. If a student forgets something or you need to drop some paperwork off, there will be a container outside the main entry door. Please hit the Aiphone button and let us know that you have placed something in there!

Division

2020-21
Student Entry
Doors

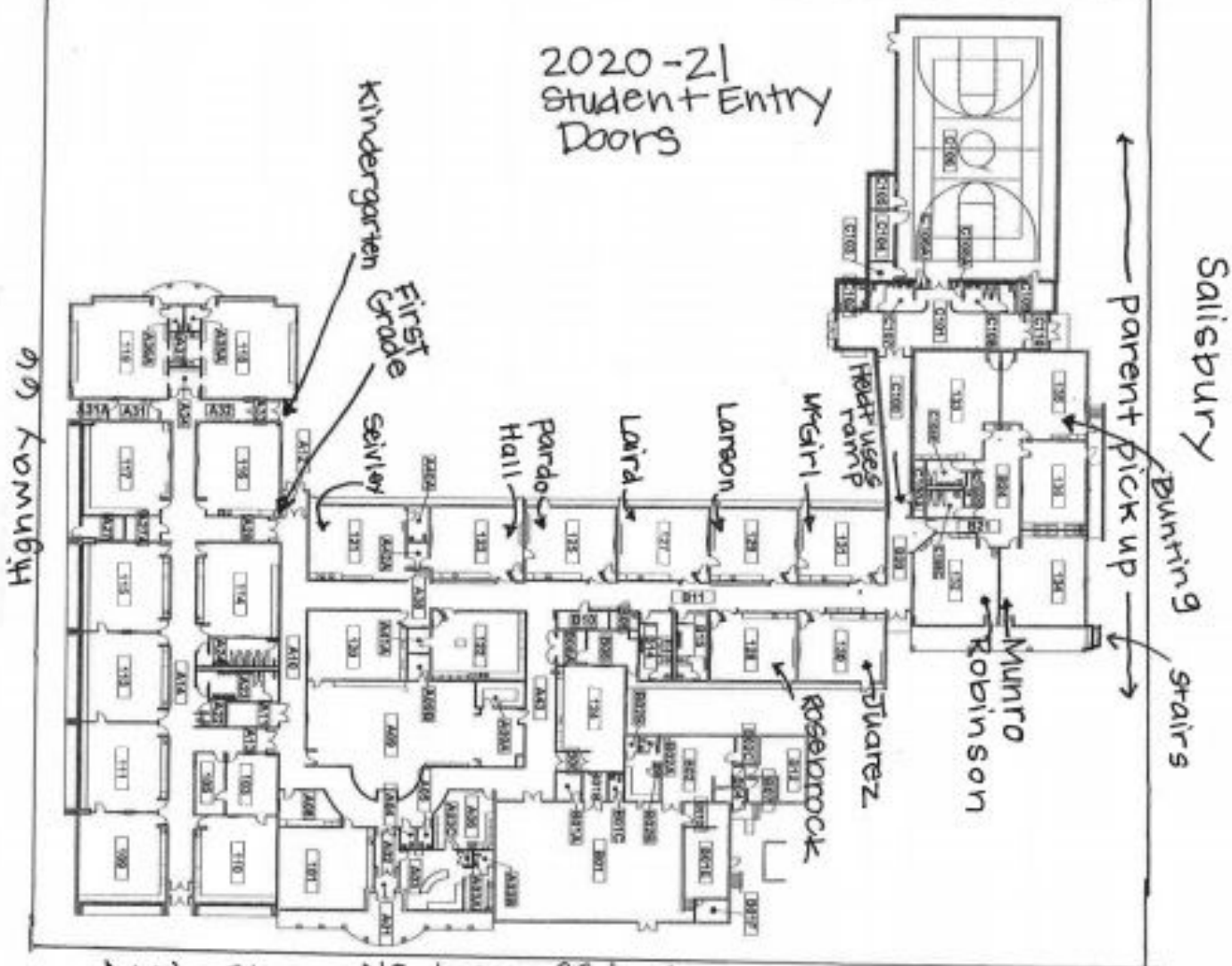

Salisbury

parent pick up →

Bunting stairs

stairs

Highway 670

Main St.

No drop off in front of school!

Staff Temperature Screening

Staff is responsible for taking their own temperature each day as well as monitoring their symptoms. Staff will complete a quick form each day saying that they screened themselves.

Student Temperature Screening

Normal student temperature range:

If a student is not themselves or looks ill and doesn't have a fever, treat that student as if they were sick.

High Temperature: Teacher calls office and Health clerk will come to room; have the student wait in the doorway 6 feet away from the rest of the people in the room. Aides will support teachers with temping as needed.

Quarantining/Outbreaks

Below is a chart adapted from CDPHE's "Covis-19 Guidance: Cases and Outbreaks in Schools" regarding who and when someone would have to quarantine.

One student with probable or confirmed COVID-19	<ul style="list-style-type: none">• Student stays home until released from isolation (usually 10 days after symptom onset, 24+ hours symptom free, and improving symptoms)• Confirmed: Cohort (grade level) quarantine at home for 14 days• Suspected: Cohort (grade level) should quarantine at home for 14 days
One teacher/staff with probable or confirmed COVID-19	<ul style="list-style-type: none">• Teacher/staff stays home until released from isolation (usually 10 days after symptom onset, 24+ hours symptom free, and improving symptoms)• All close contacts (students, teachers, and staff) should quarantine at home• If a classroom teacher, the grade level cohort should quarantine at home
OUTBREAK Two or more people from separate households in same cohort	<ul style="list-style-type: none">• Students/staff stay home until released from isolation (usually 10 days after symptom onset, 24+ hours fever free without fever reducing medication and improving symptoms)• Cohort (grade level) quarantines at home for 14 days
OUTBREAK Two or more people in	<ul style="list-style-type: none">• Students/staff stay home until released from isolation (usually 10 days after symptom onset, 24+ hours symptom free, and

different Cohorts	<ul style="list-style-type: none"> improving symptoms) All classes and staff quarantine at home for 14 days
OUTBREAK 5% or more of students/staff have confirmed COVID-19 within a 14 day period	<ul style="list-style-type: none"> Students/staff stay home until released from isolation (usually 10 days after symptom onset, 24+ hours symptom free, and improving symptoms) All classes and staff quarantine at home for 14 days

***In the event that a cohort or the entire school is quarantined, all instruction would switch to remote learning. Students will be bringing their device back and forth with them from school each day, K-5. Please help your child make sure their device is charged.**

Dismissal

Students will be released in small groups by type of transportation- walking, bus riders, and parent pick up.

Parents may wait for their student on the playground, but must enter the playground via one of the outside gates, not through the breezeway.

Kindergarteners must be picked up by someone if they are not riding the bus. This can be a parent, authorized family member, or older sibling.

There is no parking in the bus lane and in the parent pick up lane on the North side of the building. Due to cohorting, students cannot be called to the office to wait to be picked up early. Students will need to be called when the parent arrives. The parent will announce their arrival to the front office through the Aiphone, then wait outside for their child to come to them. Leaving early often adds up to a lot of learning time, so please only do so sparingly!

Lunch

Cafeteria Capacity

The PES cafeteria and tables allow for 96 spaces while social distancing students. Because of this, lunch will run similar to the past.

Separating Grade Level Cohorts

During good weather, one grade level will eat lunch outside in the picnic area and one grade level inside the cafeteria.

When eating outside is not possible, the grade levels will be physically separated from each other in the cafeteria.

Lunch Schedule

Lunch is monitored by the grade level aides. There should be at least 2 staff members in every lunch.

Grade Levels	Handwashing Time	Lunch Time in Cafeteria
Kindergarten & First Grade	11:50-12:00 PM	12:00 PM-12:20 PM
Second Grade & Third Grade	12:15-12:25 PM	12:25-12:45 PM
Fourth Grade & Fifth Grade	12:35-12:45 PM	12:45-1:05 PM

Lunch Line

The lunch line will go along the bathroom wall again this year. Kitchen staff will place dots that are socially distanced on the floor in the cafeteria.

If the line reaches to the cafeteria door, it is to then wrap into the hallway, staying socially distanced as much as possible.

Beyond the Classroom

Specials

In order to limit cohort interaction, we will have each class have the same special for two weeks. They will then switch to a new special for the next two weeks. All equipment will be disinfected between use.

Music Performances

PES will be suspending music performances for the time being.

Assemblies

Any large gathering of the whole school is not currently allowed per CDPHE guidelines, so no assemblies will be scheduled first semester.

Star Cart

The Star Cart will still come around, just less frequently. Students will use an order form to order what they would like to buy instead of the cart going to each room.

Student Services

Reading Intervention: Will concentrate on two grade levels to limit cohort contact. Mrs. Reams will be supporting 3rd grade remote learners.

Math Intervention: Will concentrate on two grade levels to limit cohort contact. Mrs. Albert will be helping 2nd grade remote learners.

ELL: ELL students will be pulled and taught in the ELL classroom. The room will be disinfected between use. Students should wash their hands when returning from a different space. Mr. Loughran, our new ELL teacher, will be providing services for our remote ELL students.

GT: The District has hired a new GT director who will communicate her instructional plans soon.

Special Education: Special education will pull groups. The paraeducators in special education will be flooding grade levels with high numbers of students on IEPs. Related services like speech and OT will be provided outside of the classroom while maintaining social distancing. Students should wash their hands when returning from a different space.

Counseling: Will be rotating for in-person counseling lessons but will also provide classrooms with videotaped lessons to use. She will still be seeing students who need support.

Recess

Each grade level cohort will have two 15 minute recesses. One will be in the morning and one will be in the afternoon. The instructional aide(s) will monitor these recesses.

The playground equipment will be used on a weekly rotation to allow for a three day weekend for disinfecting. Each grade level will know when it is their time to have a turn using the equipment.

Hand Washing

Hand washing will be explicitly taught to all students at the beginning of the year.

Teachers are to schedule handwashing times where they make sense within their day.

Students should wash their hands when returning from a different space.